

## Shower trays SIENA

Acrylic shower tray

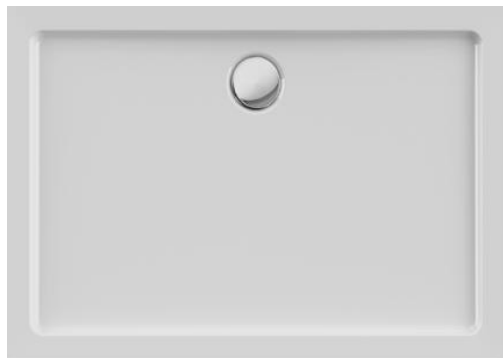

UV  
Resistant



Slip  
Resistant



Stain  
Resistant



Easy to Clean  
and Maintain



International  
Fire-spread  
Compliant



Product  
service

### Models:

Shower tray SIENA square

Shower tray SIENA rectangular

Shower tray SIENA semi-circular

### Technical information

Material	Model	Dimension [cm]	Weight [kg]	Dimension [cm]	Weight [kg]
100 % sanitary cast acrylic	square	80x80 90x90	12 kg 14 kg	100x100	19 kg
	rectangular	90x75	11 kg	100x90	18 kg
		170x75	21 kg	120x90	19 kg
		100x80	17 kg	140x90	21 kg
		120x80	19 kg	120x100	25 kg
	semi-circular	80x80 90x90	12 kg 14 kg	100x100	20 kg
Remark:	<ul style="list-style-type: none"> <li>- drainage hole Ø90</li> <li>- depth 4,0 cm</li> <li>- shower trays are delivered without siphon</li> </ul>				

### Declared properties

Tested properties	Requirement according to the European Standard	Confirmed level
- durability and cleanability	EN 14527:2016 +A1:2018 – 5.2 / 5.3	<b>Pass</b>  <b>Class 1</b>
- drainage of water	EN 14527:2016 +A1:2018 – 5.2.2	
- stability of bottom	EN 14527:2016 +A1:2018 – 5.3.2	
- resistance to chemical and staining agents	EN 14527:2016 +A1:2018 – 5.3.3	
- resistance to temperature changes	EN 14527:2016 +A1:2018 – 5.3.4	

### Analysis of possible risks according to EU Regulation 2023/988

Material	Recognized risk	Risk elimination or reducing process	Tests conducted	Relevant EU norm
100 % sanitary cast acrylic	Fulfilling the requirements of the Norm	Testing the product according to the requirements of the relevant standards.	TÜV SÜD Test report No. 713299992-3 from 05.10.2023. Aquaestil Plus Laboratory test report No. TTK-230111 from 11.01.2023.	DIN EN 14527:2019 HRN EN 14527:2016 +A1:2018
	Hygiene and health risk	According to its composition, the product is intended for household use, but not for water consumption	TDS from supplier	EN 263:2008
	Slipperiness of the acrylic surface	When getting in and out of the bathtub, hold on to a solid object or a handrail near the bathtub. Finishing the roughness of the acrylic surface by grinding or anti-slip coating.	Institute IGH d.o.o. 72530-OI-614-24 from 06.06.2024. Slip resistance of the floor covering	HRN EN 16165:2021, addition C (DIN 51097:1992)
	Flammability	Do not leave smoldering or hot objects on the acrylic surface. It is not spontaneously flammable, but it is a flammable material and has no self-extinguishing properties.	TDS from supplier class 3 / class 4	DIN 4102 BS 476 Pt. 7

Technical drawing according to the model:

## SIENA SQUARE

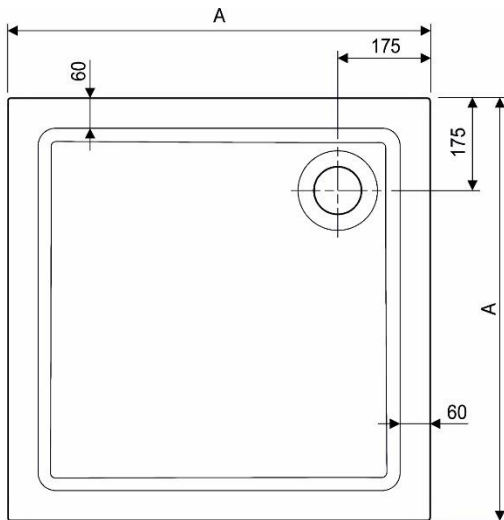

MODEL	A [mm]
80 x 80	800
90 x 90	900
100 x 100	1000

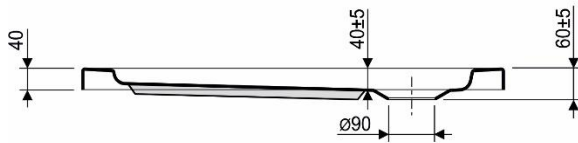

## SIENA SEMI-CIRCULAR

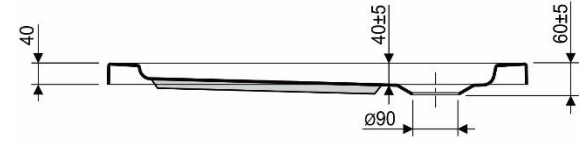
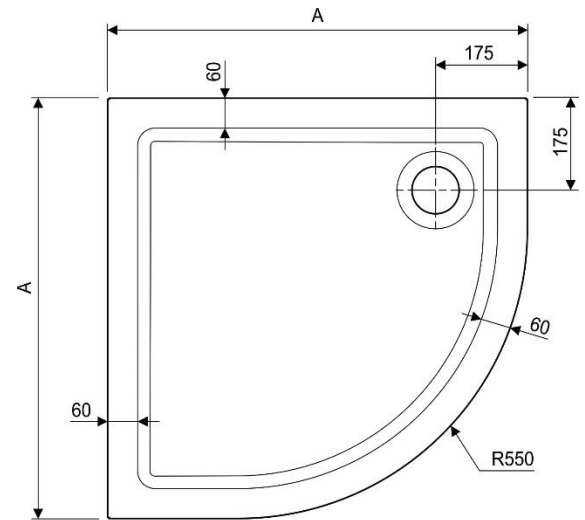

## SIENA RECTANGULAR

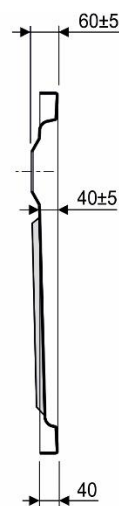
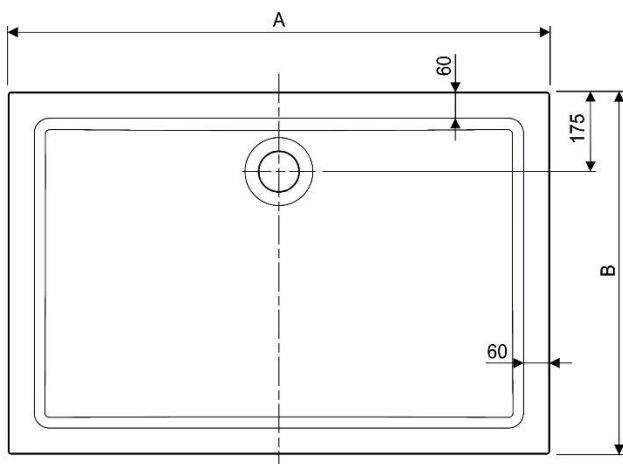

MODEL	A [mm]	B [mm]
90 x 75	900	750
100 x 80	1000	800
100 x 90	1000	900
120 x 80	1200	800
120 x 90	1200	900
120 x 100	1200	1000
140 x 90	1400	900
170 x 75	1700	750

